

Model 8 Series, Shaft output and Spindle output drives----technical specification

output torque (N.m)		Ratio (i)		Recommend Hydraulic Motor pilot/hubs and input spline	Max. input speed (rpm)	Brake torque (N.m)	Brake work pressure (bar)
normal	Max. Intermittent						
7000	14000	3.54, 4.00, 4.67, 5.71	Single reduction	SAE A, B motor pilot/hubs 13T - 16/32 Spline 15T - 16/32 Spline 14T - 12/24 Spline 21T - 16/32 Spline	3500	440	22-50
		15.92, 18.78, 21.23	Double reduction			330	27-50
		24.76, 30.33, 37.71				260	22-50
		43.36, 51.43				160	17-50

- Input-Output rotate same direction.
- Other ratio and other input type can special design.

FEATURE CHART: MODEL 8 SERIES, SHAFT OUTPUT and SPINDLE OUTPUT DRIVES, SINGLE REDUCTION							
OPTIONS	DESCRIPTION	ORDER NUMBER	USE OPTION ORDER CODES TO BUILD ORDER NUMBER				
MODEL SERIES	MODEL 8	8T	8T				
MOTOR PILOT/HUBS	SAE A SAE A1 SAE B SAE B1 SAE C SAE C1 SAE D SAE D1	A A1 B B1 C C1 D D1		C			
MOTOR INPUT SPLINE <i>INPUT SHAFT OPTIONS</i>	13T - 16/32 14T - 12/24 15T - 16/32 21T - 16/32 <i>1-1/2" Keyed</i>	13 14 15 16 <i>K00</i>			14		
RATIO OPTIONS	3.54, 4.00, 4.67, 5.71	03, 04, 4. 7, 05				05	
OUTPUT SHAFT OPTIONS <i>OUTPUT SPINDLE OPTIONS</i>	23T-12/24 Spline 2.00" Keyed 3.00" Keyed 20T-8/16 Spline 23T-8/16 Short 23T-8/16 Long 2.00 Round 2.56 Round 2.00 Hex 2.00 Hex 2.50 Hex <i>F1, F2, F2B, F3, F5,</i>	23 K1 K2 20 23S 23L A1 A2 H1 H2 H1B <i>F1, F2, F2B, F3, F5</i>					K1
BRAKE	160N.m 260N.m 330N.m 440N.m Without Brake	B4D B4F B4H B4L WO					WO
Example of complete order code:			8T	C	14	05	K1 WO

FEATURE CHART: MODEL 8 SERIES, SHAFT OUTPUT and SPINDLE OUTPUT DRIVES, DOUBLE REDUCTION								
OPTIONS	DESCRIPTION	ORDER NUMBER	USE OPTION ORDER CODES TO BUILD ORDER NUMBER					
MODEL SERIES	MODEL 8	8S	8S					
MOTOR PILOT/HUBS	SAE A SAE A1 SAE B SAE B1 SAE C SAE C1	A A1 B B1 C C1		B				
MOTOR INPUT SPLINE <i>INPUT SHAFT OPTIONS</i>	13T - 16/32 1" - 6B 14T - 12/24 15T - 16/32 <i>1-1/2" Keyed</i>	13 6B 14 15 <i>K00</i>			13			
RATIO OPTIONS	15.92, 18.78 21.23, 24.76 30.33, 37.71 43.36, 51.43	15, 18 21, 24 30, 37 43, 51				43		
OUTPUT SHAFT OPTIONS <i>OUTPUT SPINDLE OPTIONS</i>	23T-12/24 Spline 2.00" Keyed 3.00" Keyed 20T-8/16 Spline 23T-8/16 Short 23T-8/16 Long 2.00 Round 2.56 Round 2.00 Hex 2.00 Hex 2.50 Hex <i>F1, F2, F2B, F3, F5,</i>	23 K1 K2 20 23S 23L A1 A2 H1 H2 H1B <i>F1, F2, F2B, F3, F5</i>					20	
BRAKE	160N. m 260N. m 330N. m 440N. m Without Brake	B4D B4F B4H B4L WO						B4L
Example of complete order code:			8S	B	13	43	20	B4L

Motor mounting chart	
Motor mounting hole dimensions	Diameter
SAE A, A1 (4)-1/2"-13UNC 2B thd holes on 106.38 B. C.	φ 82.58(+0.12/0)
SAE B, B1 (2)-1/2"-13UNC 2B thd holes on 146.05 B. C.	φ 101.62(+0.13/0)
SAE C, C1 (4)-1/2"-13UNC 2B thd holes on 161.93 B. C. OR (2)-5/8"-11UNC 2B thd holes on 180.98 B. C.	φ 127.02(+0.13/0)
SAE D, D1 (4)-3/4"-10UNC 2B thd holes on 228.60 B. C.	φ 152.43(+0.13/0)
"O" Ring size: SAE A-#042, SAE B-#155, SAE C-#159, SAE D-#163	

Model 8 Series, Shaft output and Spindle output drives---dimensions

SAE A,B,C,D

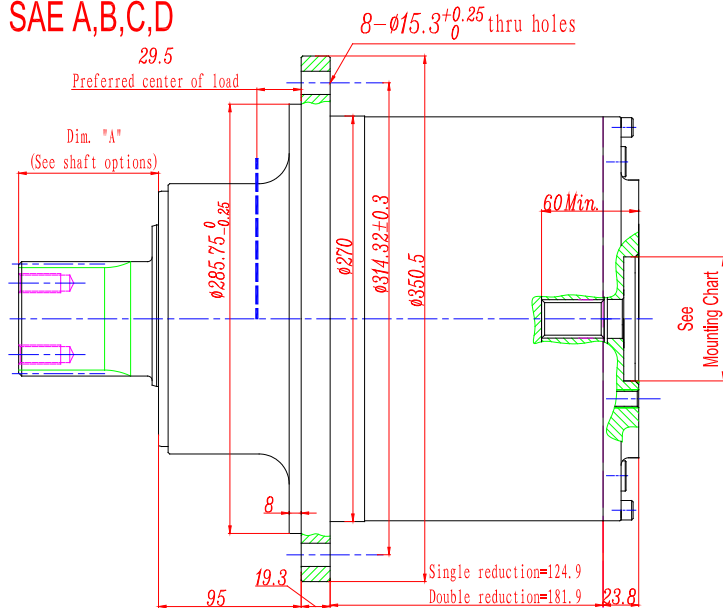

SAE A1,B1,C1,D1

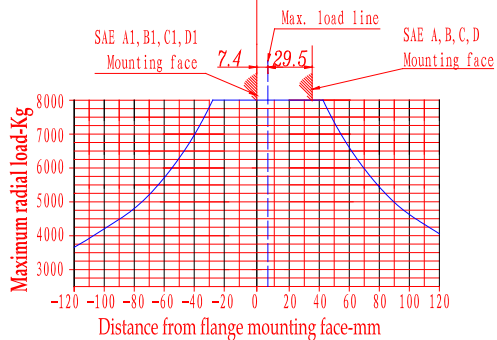
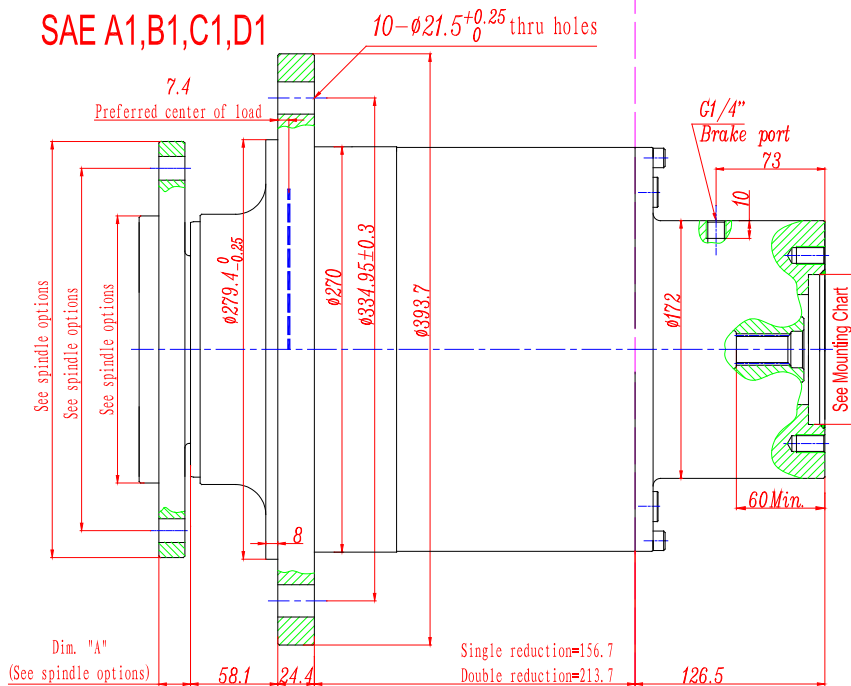

Maximum radial load on input shaft

(Based on: output speed $n_2=100$ rpm, Life=3000 h)

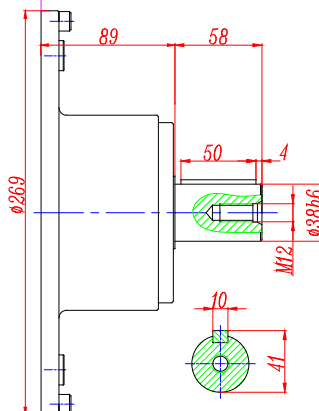

Model 8 Shaft and Spindle output options

